

TRADITIONAL INDOOR MODULAR SAUNA

am-finn.com

design@am-finn.com

1•800•237•2862



AM~FINN

INTRODUCTION

We understand remodeling an existing structure is not always the easiest solution for installing a quality sauna. As a completely freestanding structure, the Am-Finn pre-fabricated Sauna kit can be placed in almost any room or covered space with little to no room prep.



FEATURES

Am-Finn caters to your customer needs and will build your Traditional Indoor Modular Sauna to your desired dimensions.

- 7/16"x6" Spanish cedar tongue and groove panels for all walls and ceiling (vertical installation)
- 1"x4" Spanish cedar benches and supports
- Matching trim for ceiling, corners, and base
- Standard with stainless steel Am-Finn heater with external controls
- Pre-hung, solid core, cedar wood door with glass panel
- Spanish cedar bench skirts
- Tru-Tile flooring for walking area (does not cover under benches)
- FSK vapor barrier
- Vapor proof wall light
- Deluxe wall thermometer/hygrometer
- Wooden bucket and wooden ladle
- Hardware for assembly



CUSTOMIZE YOUR SAUNA

Color Wood



Spanish Cedar



Poplar Wood



Hand-Finished
Natural Black



Hand-Finished
Ivory White

CUSTOMIZE YOUR SAUNA

Wood Classic Doors

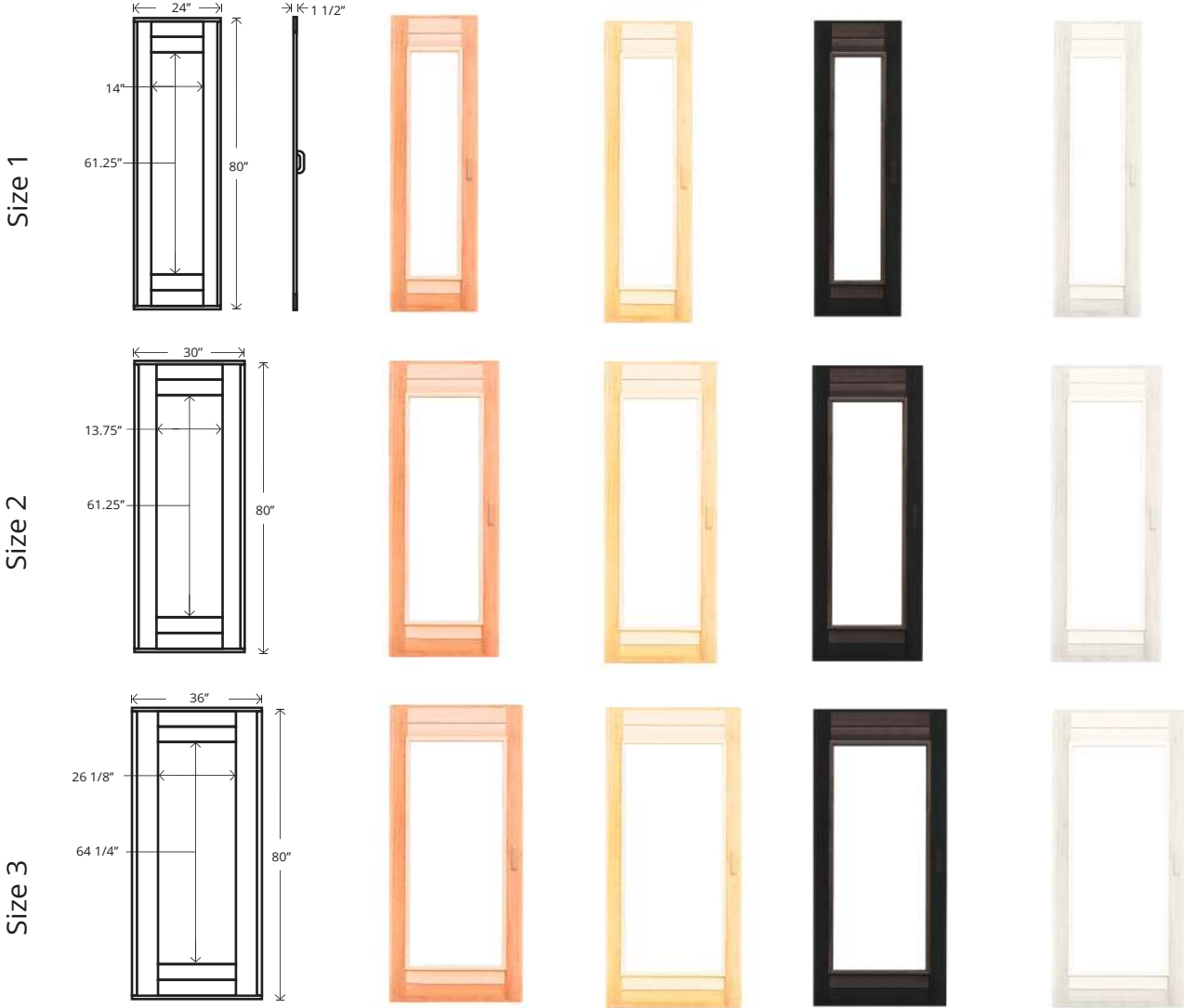

CUSTOMIZE YOUR SAUNA

Glass Doors

Clear Glass Doors

Tinted Glass Doors

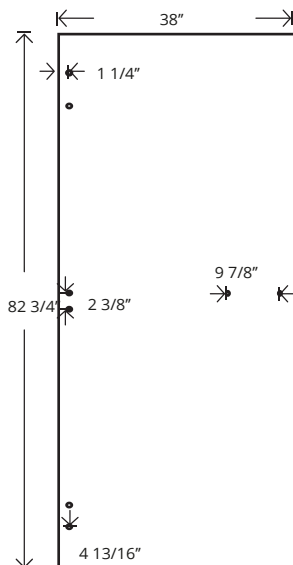
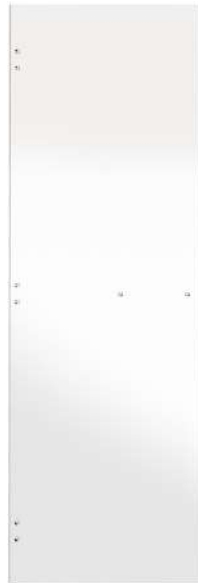
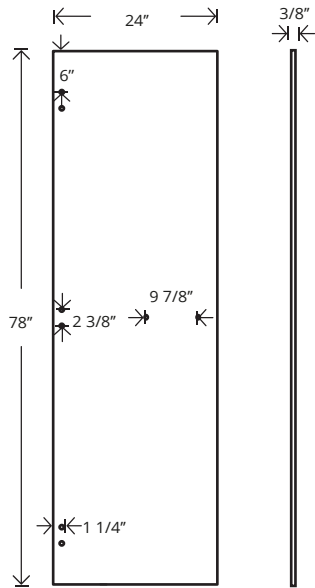

CUSTOMIZE YOUR SAUNA

Heaters



Electric Heater

Considered the best **Electric Heater** in the world. Our electric heaters are the only sauna heaters that offer a solid pan design; with 100% stainless steel construction that protects the heater components.

- Energy efficient
- Simple and clean design
- Simple installation



Gas Heater

Our **gas heater** is also highly sophisticated and built to last. These are made from 321spec stainless steel, which is the same material used in jet engine after-burners. Our gas heaters also feature the largest rock tray in the industry.

- No electricity needed
- Produces more heat
- Faster heat up time

CUSTOMIZE YOUR SAUNA

Flooring



Duck-board

An excellent option if you are looking for a high quality, traditional, flooring.

Dimensions: 24" x 24" x 1 3/8"

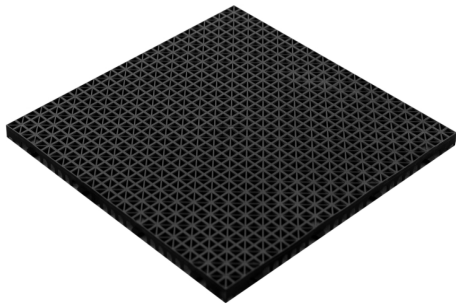

Tru-Tile

Perfect for your sauna or steam room floors. These tiles are made of PVC and interlock. Place them in your high traffic areas in your sauna or steam room.

Dimensions: 12"W x 12"L x 9/16"H

PowerZone 100



Max Room Size 1000 cu ft.







- Neutralizes and eliminates unwanted, bacteria, viruses, mold, and mildew.
- Utilizes electrolysis to convert O₂ molecules (oxygen) to O₃ (ozone).
- Reduces the use of toxic chemicals.
- Drastically decreases man-hours dedicated to traditional cleaning methods of saunas and steam rooms.

CUSTOMIZE YOUR SAUNA

Smart Sauna Wi-Fi Controller

Our Smart WiFi Controller allows you to regulate your sauna from anywhere in the world with our smartphone app.

Features

-  Time selector from 0 to 60 minutes
-  Temperature option from 75 to 180 °F
-  °C / °F option
-  Control the Ultra-Sauna Heater in the mobile application anywhere and anytime
-  3.5" Touch Sreen Controller
-  Integrated to the Cloud
-  Chromotherapy Lights

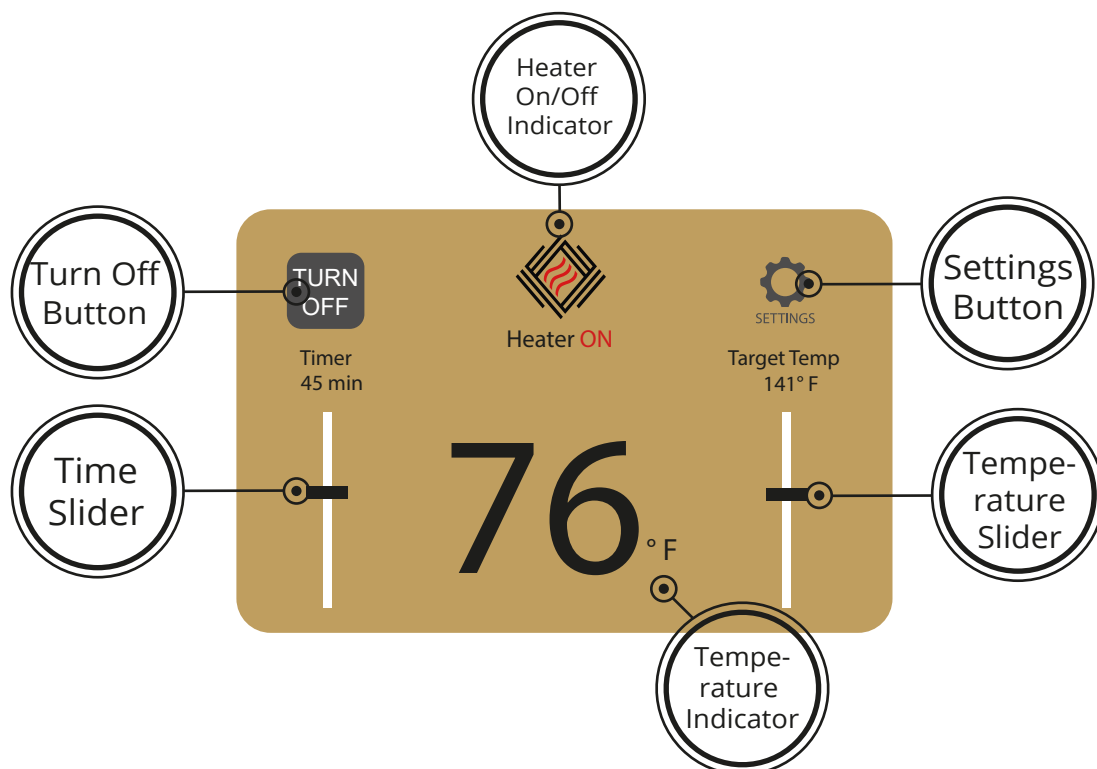

CUSTOMIZE YOUR SAUNA

Himalayan Salt Panels

Our Himalayan Salt Wall Panels make an excellent addition to your sauna room. They have an aesthetic appeal plus a unique functionality that creates a beautiful look, along with the health benefits of himalayan salt itself.

Features

- Made from 100% authentic himalayan salt blocks
- Choose between pink, red or white panel colors
- Available with LED lighting with remote
- Proprietary mounting system for easy installation
- Easily removable for cleaning, maintenance or repair
- Panels measure 16"W x 18"H x 1.75" thickness



Pink Salt Panel



White Salt Panel



Red Salt Panel

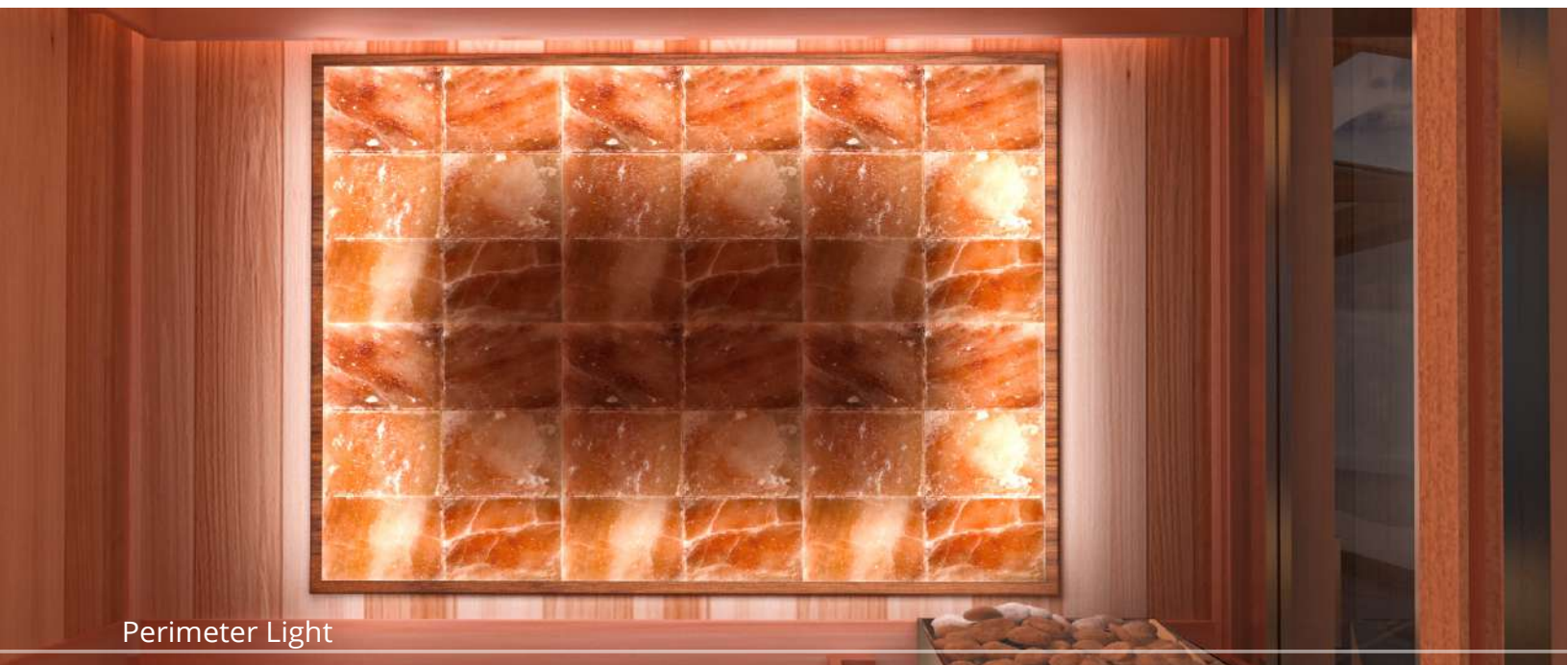

Perimeter Light

GALLERY

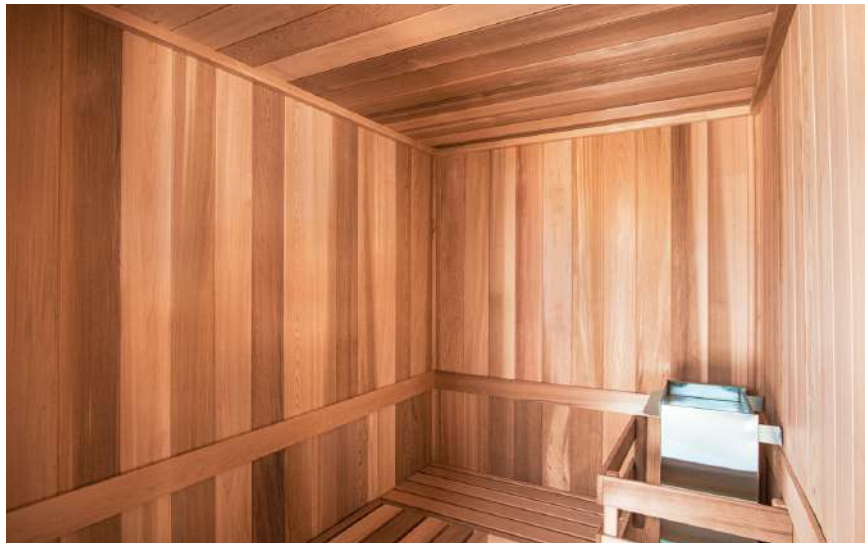



AM~FINN

1•800•237•2862

design@am-finn.com

am-finn.com